

### Description

The SIPP roller shutter box is a box prefabricated in EPS expanded polystyrene which will be anchored to the concrete lintel. The trunk body is composed of :

- A reinforced expanded polystyrene shell,
- A welded mesh reinforcement,
- Two aluminum profiles serving as a coating stopper finishing on the outside of the shell and support for the underside,
- One-piece side panels to clip on at both ends of the trunk which will be used to receive the shutter axis supports rollers and fix the underside.

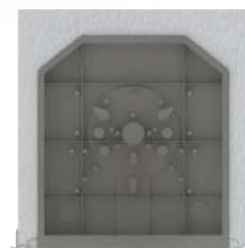
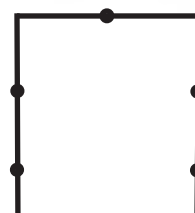

### Area of use

The trunk can be equipped with all types of roller shutters thanks to with adaptable side panels. It is a prefabricated chest which will be perfectly anchored to the lintel with a raised surface for better adhesion of the coating.

### Technical Characteristics

#### WELDED MESH

- Link (central): 300/185 mm
- Link (lateral): 300/125 mm
- Section of longitudinal steels: Ø5 mm
- Section of transverse steels: Ø4 mm

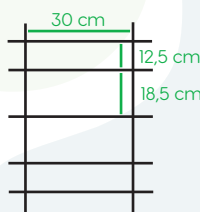

#### POLYSTYRENE SHELL

- Average density: 30
- Thickness of side walls: 30 mm
- Top wall thickness: 40 mm
- Hull width: 300 mm
- Hull height: 300 mm

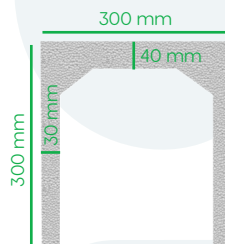

#### ALUMINUM PROFILE

- Thickness: 1.1mm
- Coating stop width: 10mm with 1mm return
- Depth of Support under face: 10 mm

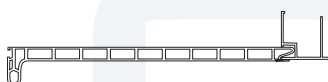

#### MONOBLOCK CHEEKS

- Materials: Injected plastic under pressure
- Equipment: Two clips for hanging in the hull in polystyrene
- A tab to ensure fixing the underside

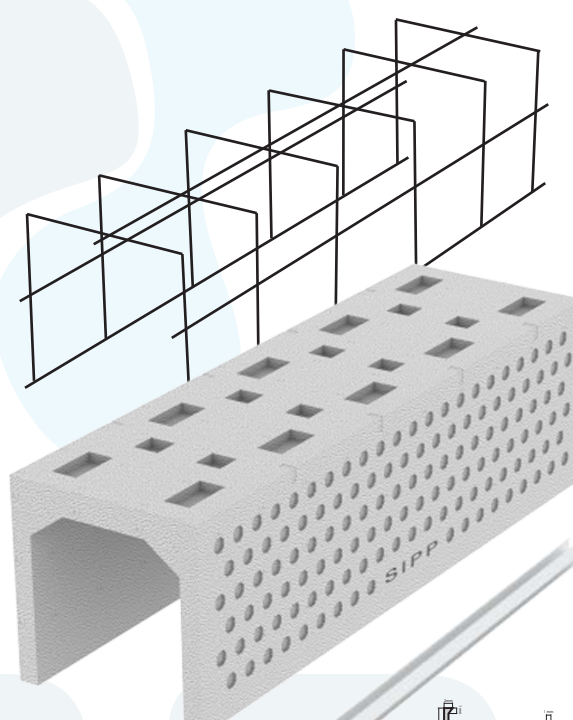
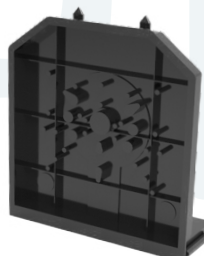
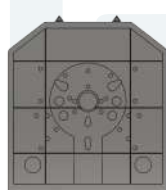

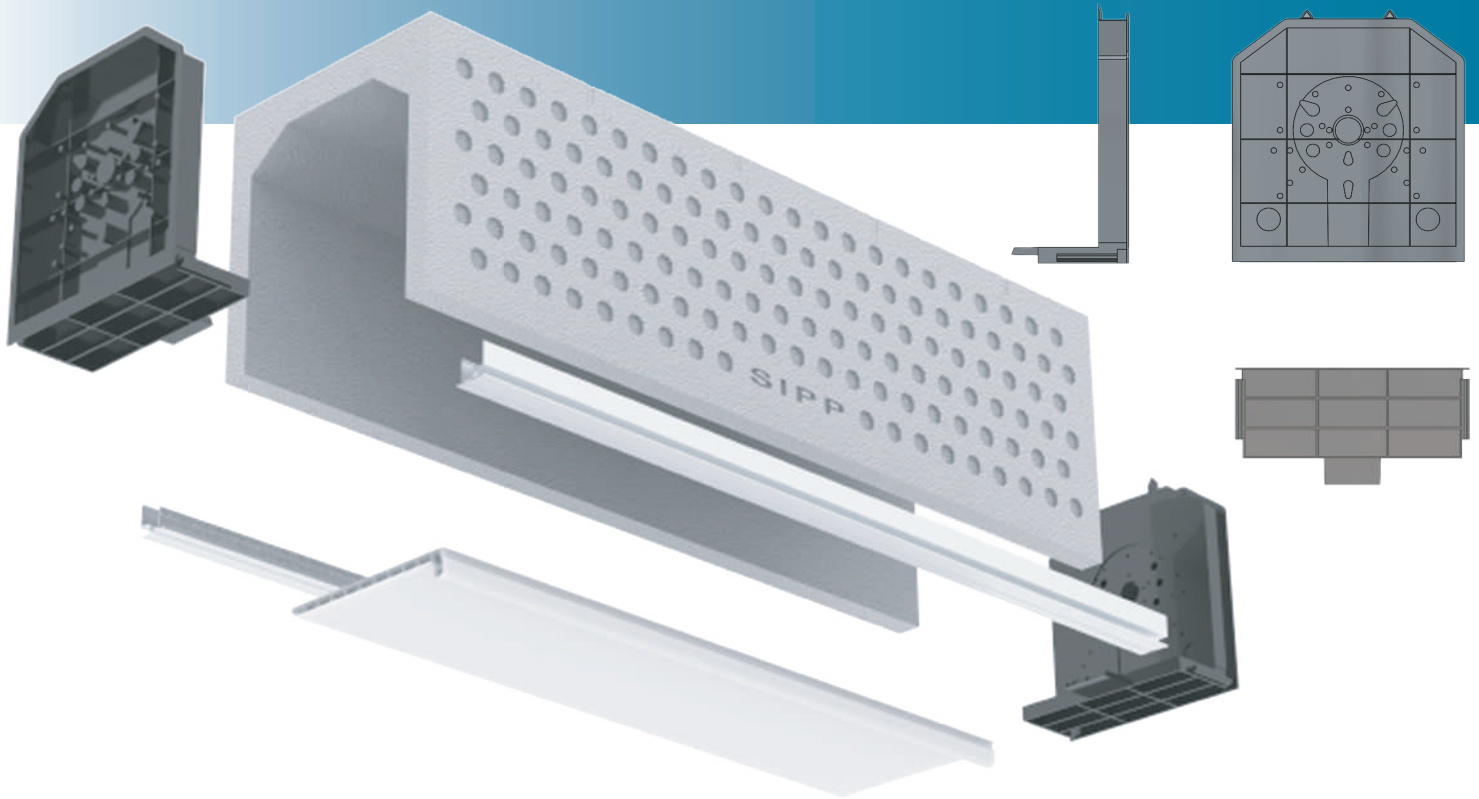

## The different dimensions of roller shutter boxes

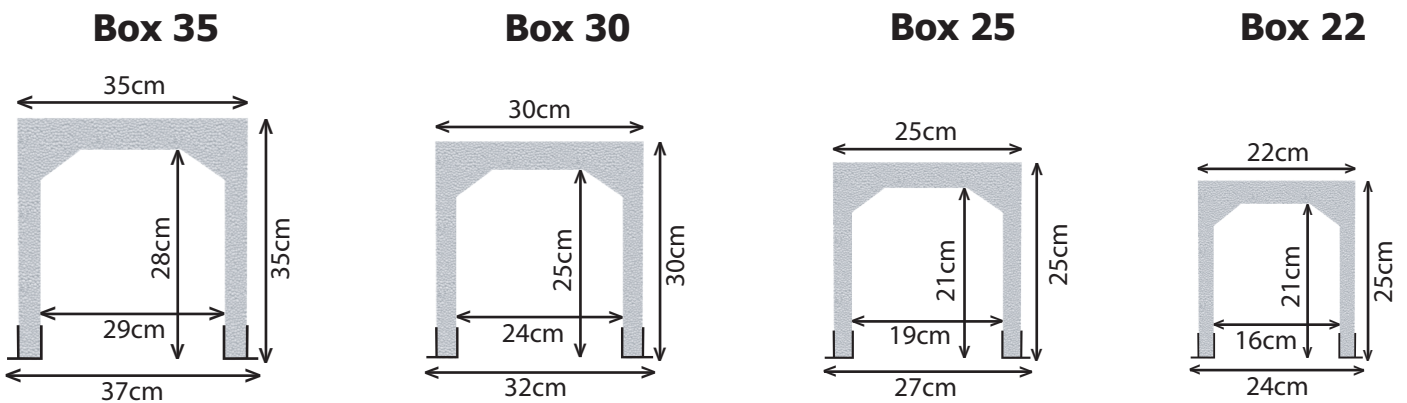

## The correspondence matrix

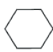
		CVR 22		CVR 25		CVR 30		CVR 35	
<b>LAME 45</b>	AXE40	1.80	METRE L	2	METRE L	2.40	METRE L	-	METRE L
		40	PIECES	45	PIECES	53	PIECES	-	PIECES
	AXE60	1.60	METRE L	1.80	METRE L	2.20	METRE L	3.10	METRE L
		36	PIECES	40	PIECES	49	PIECES	68	PIECES
	AXE70	-	METRE L	1.60	METRE L	2	METRE L	3	METRE L
		-	PIECES	36	PIECES	45	PIECES	66	PIECES
AXE80	-	METRE L	-	METRE L	1.8	METRE L	2.8	METRE L	
	-	PIECES	-	PIECES	40	PIECES	62	PIECES	
<b>LAME 55 (EXTRUDE)</b>	AXE40	-	METRE L	-	METRE L	-	METRE L	-	METRE L
		-	PIECES	-	PIECES	-	PIECES	-	PIECES
	AXE60	-	METRE L	1.20	METRE L	2.39	METRE L	3	METRE L
		-	PIECES	22	PIECES	46	PIECES	55	PIECES
	AXE70	-	METRE L	1.10	METRE L	2.37	METRE L	2.8	METRE L
		-	PIECES	20	PIECES	44	PIECES	51	PIECES
	AXE80	-	METRE L	1	METRE L	2.35	METRE L	2.6	METRE L
		-	PIECES	18	PIECES	42	PIECES	47	PIECES

